



SCHOOL DISTRICT OF
Poynette

February 7, 2018

**COMMUNITY FACILITY
ADVISORY COMMITTEE**

LEARN MORE www.poynette.k12.wi.us



WHAT ARE YOU HEARING?



AGENDA & GOALS

- Compare area tax impacts & mill rates
- Recap committee work
- Review prioritization & ongoing work
- Review survey & goals
- Table discussion
- What's next?



COMMITTEE CHARGE

The Board of Education of the School District of Poynette authorizes the creation of a Community Facility Advisory Committee (Committee) to be charged with the task of seeking solutions to our District's facility needs. The Committee is charged to review all pertinent information found in the District's completed Facilities Assessment. The Board desires the following to be considered by the Committee in making a facility recommendation to the Board of Education for future action:

- Options should reflect the **District's mission and goals**
- Options should include purposeful spaces to inspire **21st Century learning, accommodate evolving technology and promote collaboration**
- Options may include **new construction, renovations, repurposed spaces, and/or upgrades** to support learning environments
- Options should include spaces for **students, staff, parents, and community**
- Options should be **cost-effective** for taxpayers, energy efficient and adaptable for future use



TAX IMPACTS & MILL RATES

Summary of Tax Impacts

REFERENDUM AMOUNT	\$12,500,000	\$25,000,000	\$30,000,000	\$35,000,000	\$40,000,000	\$60,000,000
MAX MILL RATE IMPACT (in 2019-20) (Per \$1,000 valuation)	\$0.00	\$1.34	\$1.89	\$2.38	\$2.86	\$5.08
TAX IMPACT ON PROPERTY WITH FAIR MARKET VALUE OF:						
\$100,000 Home						
Maximum Impact	\$0.00	\$134.00	\$189.00	\$238.00	\$286.00	\$508.00
Monthly Impact	\$0.00	\$11.17	\$15.75	\$19.83	\$23.83	\$42.33
\$200,000 Home						
Maximum Impact	\$0.00	\$268.00	\$378.00	\$476.00	\$572.00	\$1,016.00
Monthly Impact	\$0.00	\$22.33	\$31.50	\$39.67	\$47.67	\$84.67
\$300,000 Home						
Maximum Impact	\$0.00	\$402.00	\$567.00	\$714.00	\$858.00	\$1,524.00
Monthly Impact	\$0.00	\$33.50	\$47.25	\$59.50	\$71.50	\$127.00



Assumptions:

Phased approach with estimated interest rates of 4.00% - 5.25%.

Mill rate based on 2017 Equalized Valuation (TID-OUT) of \$679,010,599 with annual growth of 0.00%.

Mill rate will increase an estimated \$0.11 for each additional million borrowed.

Recent Higher Tax Impact Debt Referenda



District	Vote Date	Amount	Estimated Impact	Results
Dodgeville	11/4/2014	\$48,000,000	\$3.75	Failed
Randolph	4/7/2015	\$17,570,000	\$3.55	Passed
Boscobel	4/5/2016	\$20,000,000	\$2.93	Failed
Weyauwega	11/8/2016	\$21,000,000	\$2.65	Passed
Parkview	4/1/2014	\$17,000,000	\$2.53	Passed
Johnson Creek	4/1/2014	\$18,900,000	\$2.49	Passed
Melrose-Mindoro	11/8/2016	\$24,700,000	\$2.22	Passed
Cameron	11/5/2013	\$23,500,000	\$2.16	Passed
Barneveld	11/7/2017	\$12,900,000	\$2.13	Passed
Dover	2/21/2017	\$4,200,000	\$2.13	Failed
Peshtigo	4/5/2016	\$33,900,000	\$2.11	Failed
Peshtigo	11/3/2015	\$32,995,000	\$2.03	Failed
Dodgeville	4/5/2016	\$19,995,000	\$1.89	Passed
Milton	11/8/2016	\$87,000,000	\$1.77	Failed
Chippewa Falls	11/8/2016	\$98,000,000	\$1.76	Failed
Prescott	04/1/2014	\$27,980,000	\$1.71	Passed
Milton	11/7/2017	\$69,900,000	\$1.46	Failed

Source: Department of Public Instruction

Area Districts Debt Referendum History *(since 2015)*



District	Vote Date	Amount	Estimated Impact	Results
Pardeeville	4/4/2017	\$11,935,000	\$1.19	Passed
Baraboo	11/8/2016	\$21,950,000	\$0.40	Passed
Lodi	11/8/2016	\$22,000,000	\$0.00*	Passed
Lodi	11/8/2016	\$9,000,000	\$0.00*	Failed
DeForest	4/7/2015	\$41,000,000	\$0.16	Passed
Sun Prairie	11/08/2016	\$89,500,000	\$0.50	Passed
Wisconsin Dells	04/01/2014	\$30,000,000	\$0.84	Failed
Wisconsin Dells	9/16/2014	\$30,000,000	\$0.84	Failed
Sauk Prairie	04/01/2014	\$34,640,000	\$0.74	Passed
Reedsburg	10/10/2017	\$32,000,000	\$0.04	Passed
Fall River	4/3/2018	\$7,800,000	\$0.77	TBD

* If both questions passed, impact would have been \$0.11.

Wisconsin School Debt Referendum History

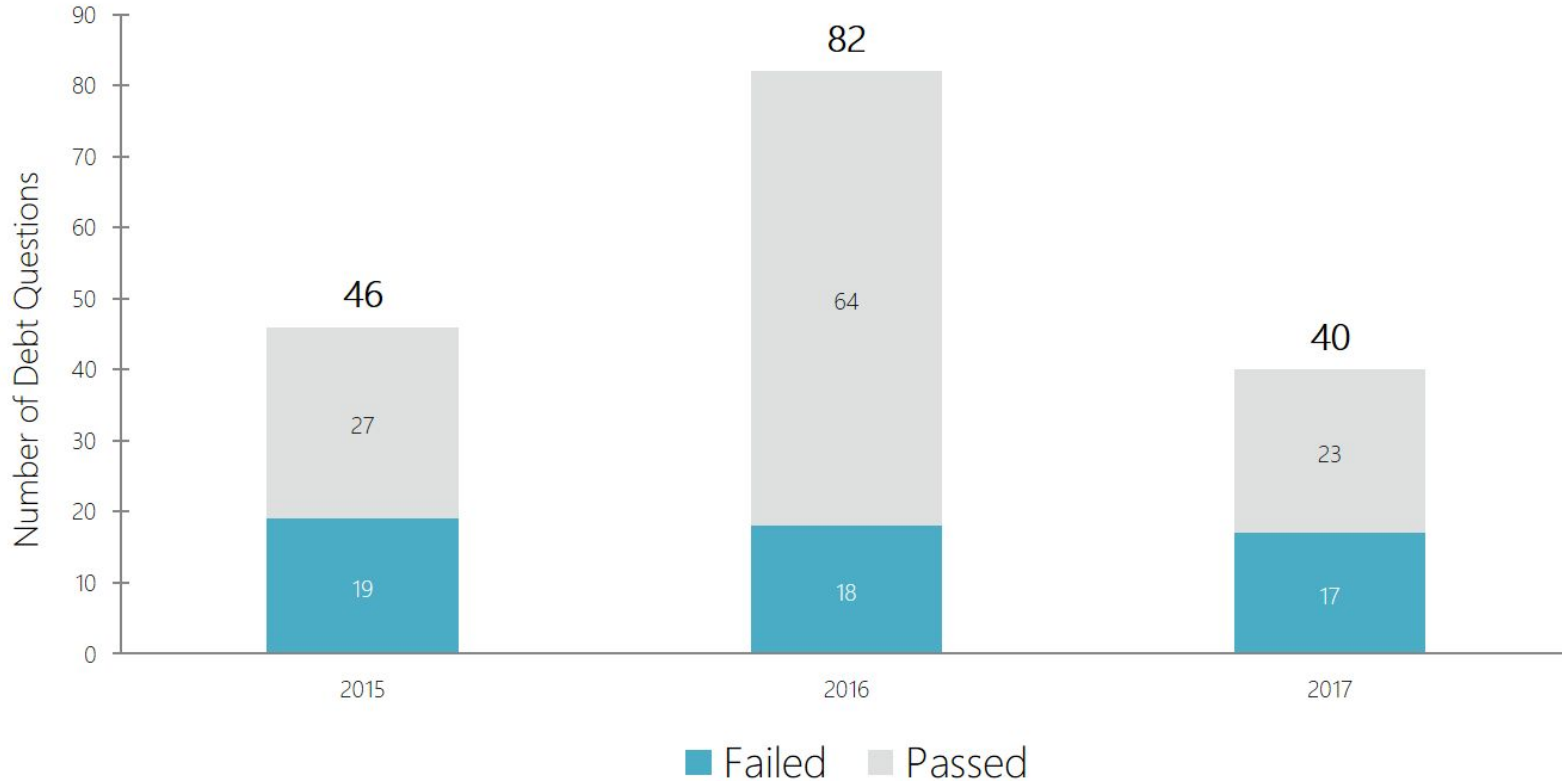

Historical Mill Rate

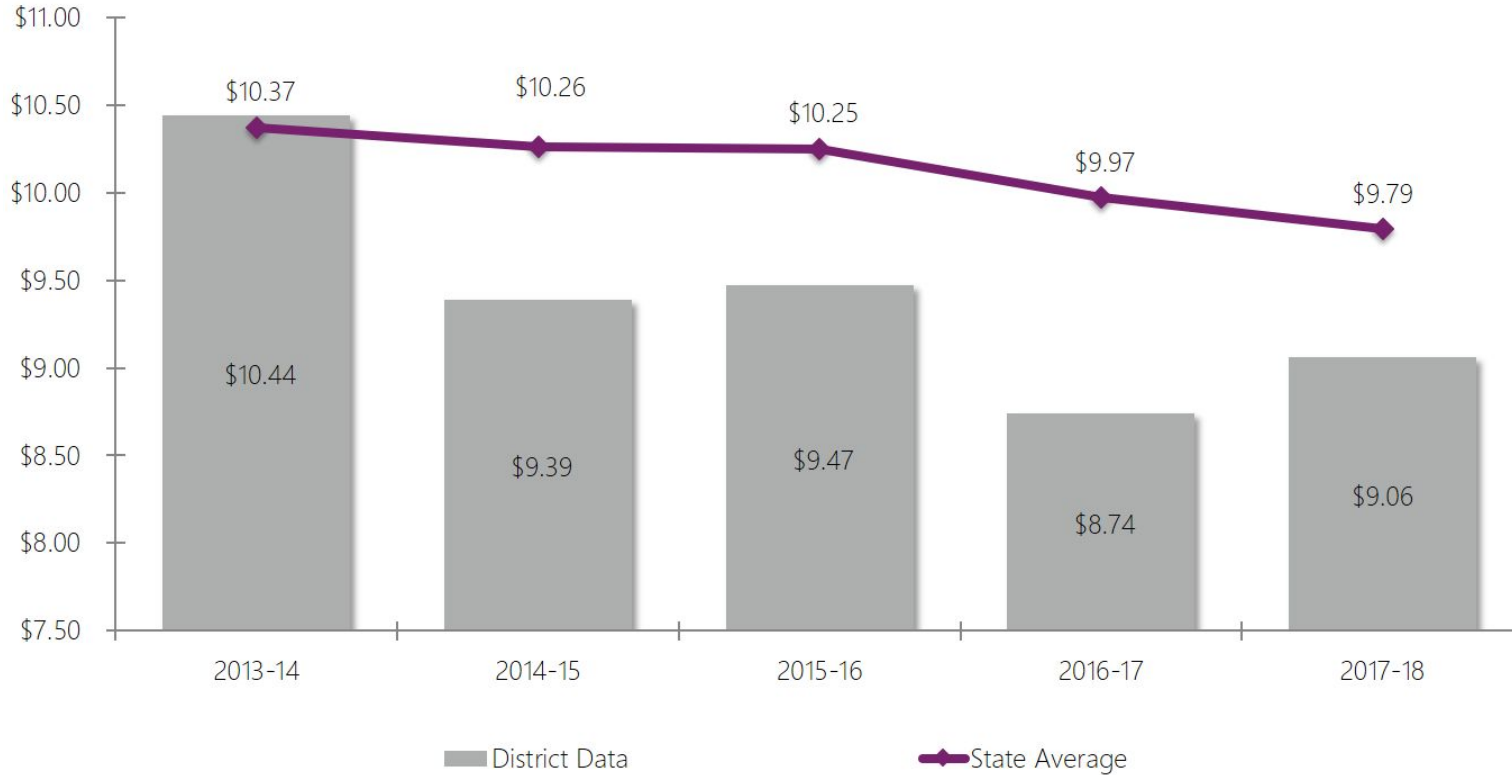

Poynette's mill rate is in the **bottom 25%** of K-12 Wisconsin Schools.

Mill Rate Comparison: 2017-18

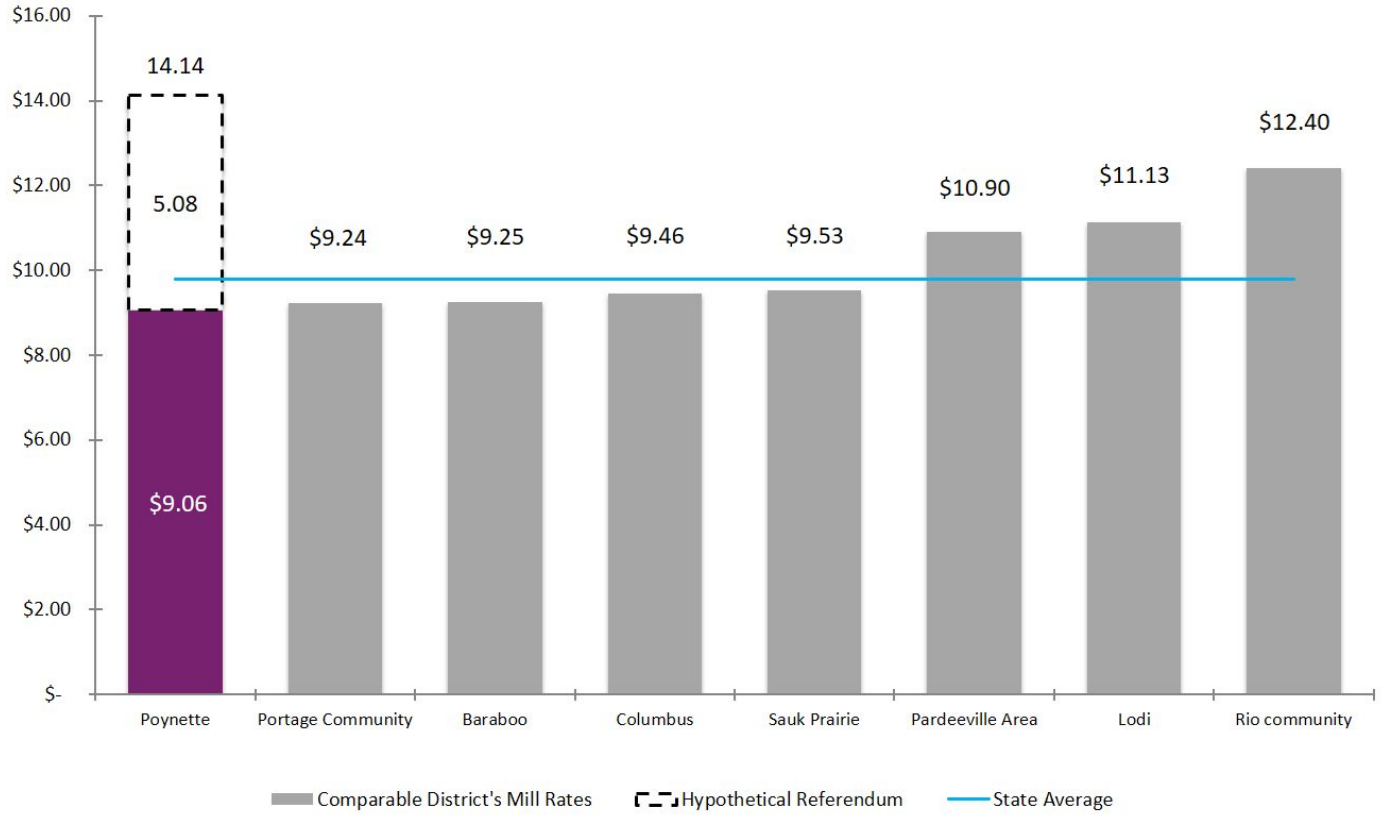

Only **15** Districts in the State have a mill rate over **\$13**, **6** Districts over **\$14**.

Mill Rate with Debt Comparison: 2017-18



Source: Department of Public Instruction



QUESTIONS

COMMITTEE WORK & PRIORITIZATION

PRIORITIZING/PHASING NEEDS

Needs		Arlington n/a	ES 1-4	MS 5-8	HS 9-12	
Identified in Facility Assessment and from building tour themes	ADA compliance	Priority 0	Priority 1			
	Athletics					
	Building systems					
	Maintenance equipment					
	Operational efficiencies					
	Safety and security					
Identified as themes through committee process	Classroom sizes meet recommended square footages					
	Collaborative learning and teaching environments					
	Community space(s)					
	Flexible furniture					
	Flexibility					
	Natural light					
	Parking/traffic					
	Fine arts (music, band, chorus, orchestra, auditorium, etc.)					
	Staffing and instructional efficiencies					
	STEM/STEAM spaces					

Themes are based on hundreds of needs identified

 Priority 1

 Priority 2

 Priority 0

PRIORITIZING/PHASING NEEDS

- Move kindergarten to new elementary school
- New elementary school
- Capital maintenance
 - ADA compliance
 - Building systems
 - Operational efficiencies
 - Safety & security
- STEM/STEAM
- Collaborative learning and teaching environments
- Flexibility
- Parking & traffic

PREVIOUS PLANS & COSTS



Poynette High School



New Elementary School Path - Option 2B

Current: 9 - 12 Grade
Proposed: 9 - 12 Grade



Upper Level

\$24,320,000 - \$26,880,000

- Deficient
- Addition
- Level 1 Renovation
- Level 2 Renovation
- Level 3 Renovation
- Demolish

UPDATED PLANS & COSTS



Poynette High School

New Elementary School Path - Option 2B

Current: 9 - 12 Grade
Proposed: 9 - 12 Grade

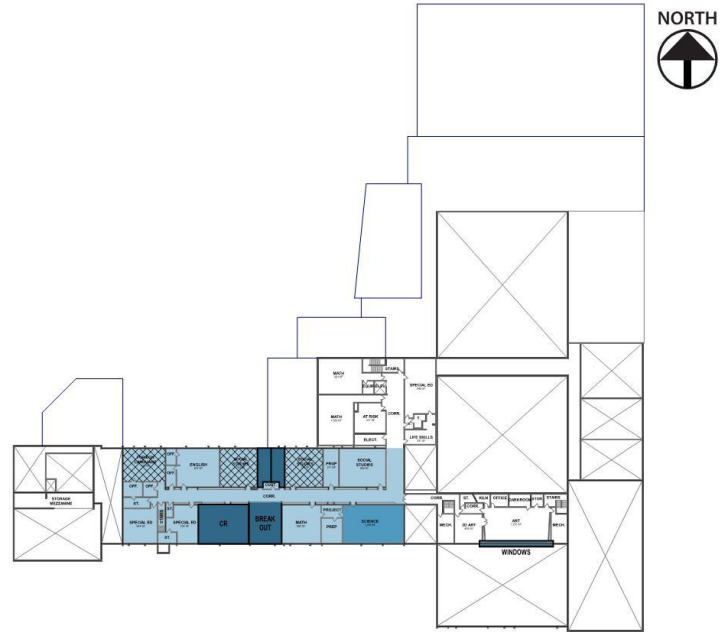
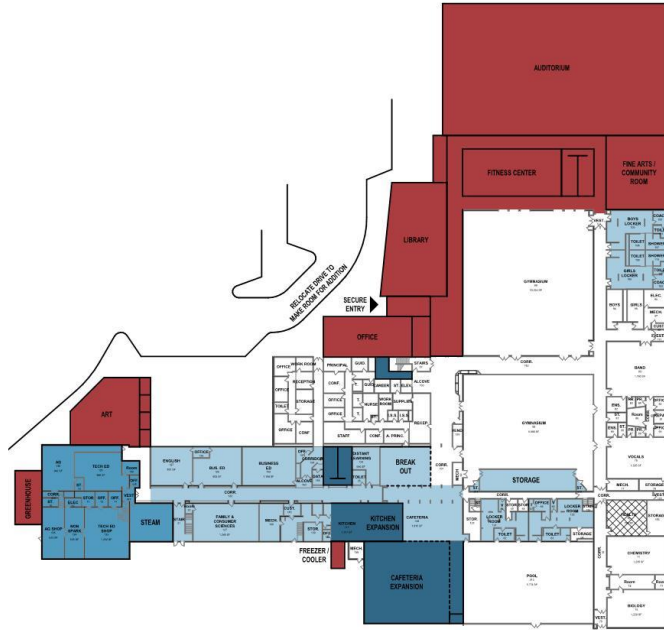

Upper Level

\$21,130,000 - \$23,350,000

⊠ Deficient ■ Addition □ Level 1 Renovation ■ Level 2 Renovation ■ Level 3 Renovation ■ Demolish



COMMUNITY SURVEY

COMMUNITY SURVEY

- Gather broad community feedback
- Give public a voice in decision-making
- Build ownership among stakeholders
- Communicate important information to community members
- Independently collect credible data

Follow the data!

COMMUNITY SURVEY

What we will test

- Long-Range Facility Plan components
 - New elementary school
 - Move K into new elementary school
 - Facility maintenance
 - STEM/STEAM
 - Various components in MS & HS (classrooms, core spaces, lifelong fitness, auditorium, etc)
- Priorities/Phases
- Tax tolerance/level of funding support



WHAT ELSE DO YOU NEED TO
LEARN FROM THE COMMUNITY
IN ORDER TO MAKE A FACILITIES
RECOMMENDATION?

WHAT'S NEXT?

COMMITTEE SCHEDULE

DATE	TIME/LOCATION	TENTATIVE FOCUS
Feb 21, 2018	6:30-8:30 PM HS	Approve final option(s) for survey
Mar 7, 2018	6:30-8:30 PM HS	Community Update
March		Community Survey
Apr 11, 2018	6:30-8:30 PM HS	Joint School Board/Committee meeting to hear survey results
Apr 25, 2018	6:30-8:30 PM HS	Refine/finalize recommendation
May 9, 2018	6:30-8:30 PM HS	Finalize recommendation <i>(if needed)</i>
May 21, 2018	7:00 PM HS	Committee delivers recommendation to board



SCHOOL DISTRICT OF Poynette

THANK YOU!

SCHOOL DISTRICT OF Poynette
SHARE YOUR INPUT

To help us provide the most beneficial and productive meetings possible, please respond to the following statements:

The meeting purpose and objectives were clearly stated.
Strongly Disagree 1 2 3 4 Strongly Agree

The meeting time was effective.
Strongly Disagree 1 2 3 4 Strongly Agree

I am satisfied with this meeting.
Strongly Disagree 1 2 3 4 Strongly Agree

My role in the District is as a parent all that apply:
 Community member Parent Grandparent Staff member Business owner Student

Other _____

I prefer to receive committee materials:
 Electronically Hard copy

Comments/Suggestions: _____

Name and Contact Information (Optional): _____
*Please let us know if you have any special needs for our consideration during the meetings.

Questions?

Matt Shappell

mshap@poynette.k12.wi.us

(608) 635-4347

LEARN MORE www.poynette.k12.wi.us



BACK-UP SLIDES

PROCESS & COMMUNITY SURVEY



Potential Referendum Schedule for the School District of Poynette

draft 1/23/18

	2016-17 School Year			2017-18 School Year															2018-19 School Year		
	Spring			Summer			Fall			Winter			Spring			Summer			Fall		
	March	April	May	June	July	Aug	Sept	Oct	Nov	Dec	Jan	Feb	March	April	May	June	July	Aug	Sept	Oct	Nov
1 POTENTIAL NOVEMBER 2018 REFERENDUM																					
2 Facility Assessment		■																			
3 Communication - Facility Assessment Findings				■																	
4 Key Decision (Benchmarks) for Board			★				★						★					★			
5 Board to Confirm Educational Priorities					■	■															
6 Hire Architect				■	■	■	■														
7 Board Meeting to Establish Committee Charge							■														
8 Community Facility Advisory Committee								■	■	■	■	■	■	■	■	■	■	■	■	■	■
9 Joint Board and Committee Workshop to Review Committee Charge								■	■												
10 Hire Survey Consultant										■	■										
11 Community Survey													■	■							
12 Joint Board and Committee Workshop for Community Survey Results														■	■						
13 Committee Recommendation to the Board															■	■					
14 Board to Consider Recommendation and Finalize Solution																■	■	■			
15 Adopt Resolution																	■	■	■	■	■
16 Referendum Communications & Outreach																		■	■	■	■
17 Potential Referendum																					■

- Key board action
- Potential work/action
- Critical referendum dates